

PG36A-EP-HT



行星齿轮箱塑料款 36(mm)

Planetary gearbox Engineering plastics Ver. 36(mm)

| 外壳材质 Housing Material | 输出轴承 形式 Bearing at output | 径向负载 (N) Radial load (10mm from flange) | 轴向负载 (N) Shaft axial load | 静态主轴最大 承受压入力 Shaft press fit force max Static (N) | 径向间隙 (mm) Radial play of shaft | 轴向间隙 (mm) Thrust play of shaft | 背隙 无负载时 Backlash at no-load |
|---------------------------------|------------------------------------|---|------------------------------------|---|---|---|--------------------------------------|
| 工程塑料 Engineering plastics | 滚珠轴承 Ball bearing | ≤450 | ≤200 | ≤500 | ≤0.03 | ≤0.1 | ≤1.5° |

*负载与转速有关, 具体数据需参考实际情况。

*Load relates to speed, actual value depends on different situation.

外型图/Mechanical Dimension

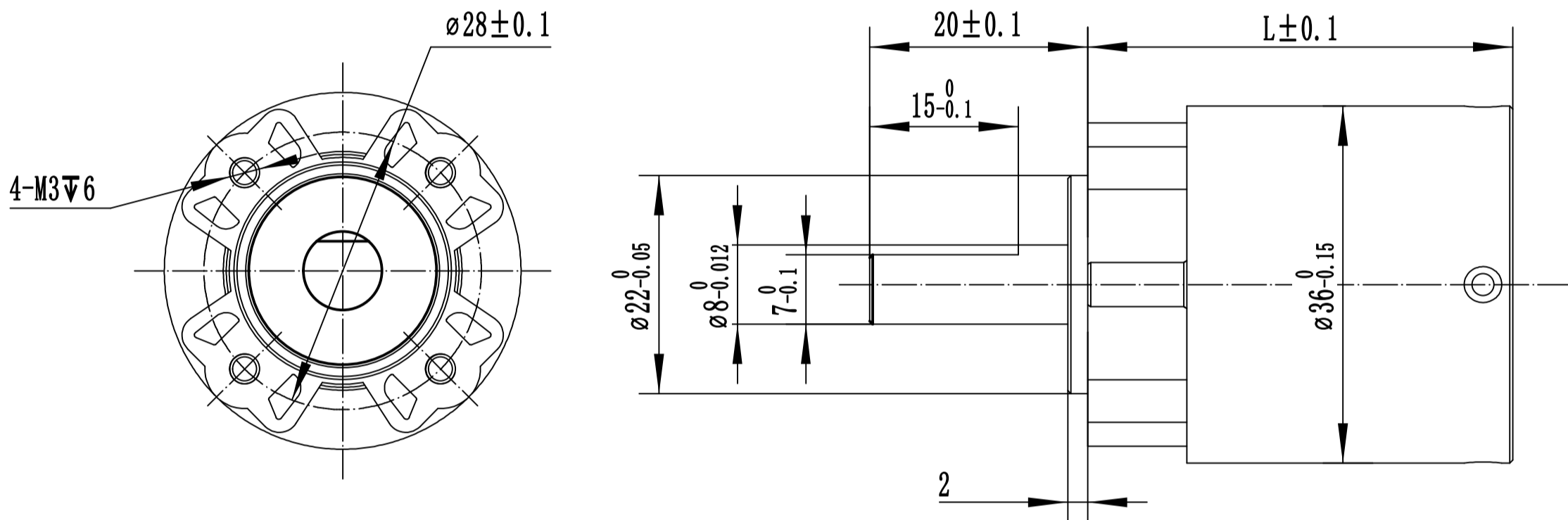

Unit:mm

标准减速比形式/Gearbox Specifications

| 减速比 Reduction Ratio | 实际减速比 Absolute Reduction Ratio | 额定允许负载 Rated Tolerance Torque (Nm) | 瞬间允许负载 Momentary Tolerance Torque (Nm) | 效率 Efficiency (%) | 长度 Length (mm) | 重量 Weight (g) | 减速比级数 Number of gear trains |
|---------------------------|--------------------------------------|---|---|-------------------------|----------------------|---------------------|-----------------------------------|
| 1/4 | 1/4.38 | 0.3 | 1.0 | 81% | 24.8 | 145 | 1 |
| 1/5 | 1/5.4 | | | | | | |
| 1/16 | 1/16.44 | 1.2 | 3.5 | 72% | 32.4 | 173 | 2 |
| 1/20 | 1/20.25 | | | | | | |
| 1/25 | 1/25.16 | | | | | | |
| 1/53 | 1/52.56 | 2.5 | 7.5 | 65% | 41.9 | 213 | 3 |
| 1/62 | 1/61.59 | | | | | | |
| 1/76 | 1/75.94 | | | | | | |
| 1/94 | 1/94.37 | | | | | | |
| 1/117 | 1/117.26 | | | | | | |